

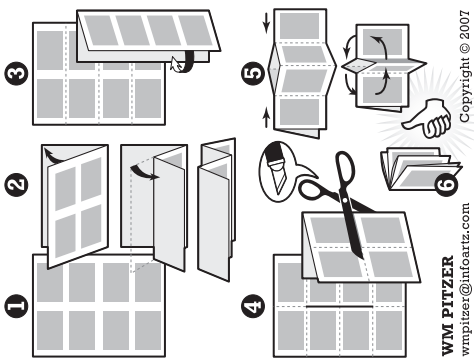

# INSIDE THE KNIGHT THEATER

WM PITZER & STEVEN BROWN  
*The Charlotte Observer*  
 M U L T I M E D I A

Copyright © 2009



WM PITZER  
 wmpitzer@tdiobartiz.com  
 Copyright © 2007

The \$32 million Knight Theater is the first of four cultural facilities to open in a South Tryon Street development spearheaded by the former Wachovia. They'll flank the 48-story Duke Energy Center, whose property taxes – along with other Charlotte-Mecklenburg tax revenue – will pay most of the construction bill.

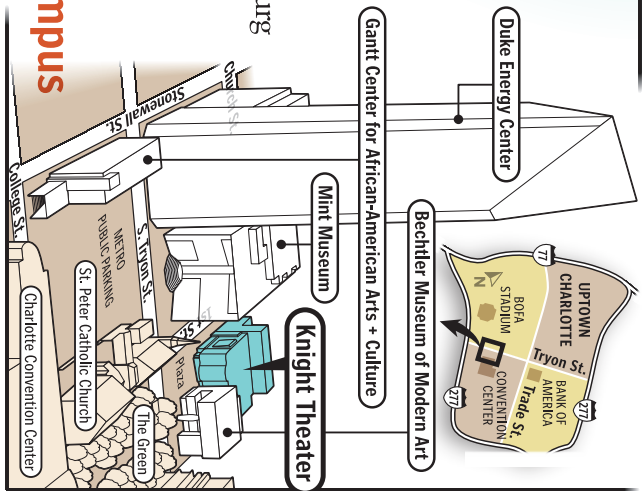

## WELLS FARGO Cultural Campus

**B** The Knight Theater has a special bond with the Bechtler Museum of Modern Art. The two venues' lobbies connect, and large windows in the Bechtler will provide theater-goers with a glimpse of its interior artworks.



**A** A 38-foot by 18-foot exterior LED screen, located on the First Street side of the theater, will display highlights from shows, public artworks and other imagery to pedestrians and patrons.

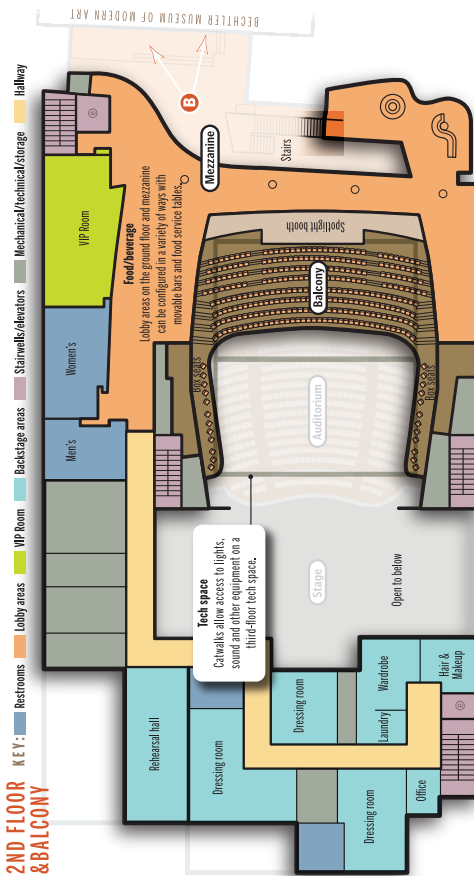

### 2ND FLOOR & BALCONY

### 1ST FLOOR

**KEY:** Restrooms (blue), Lobby areas (orange), VIP room (green), Backstage areas (light blue), Men's/Women's (purple), Mechanical/technical/storage (grey), Hallway (yellow)

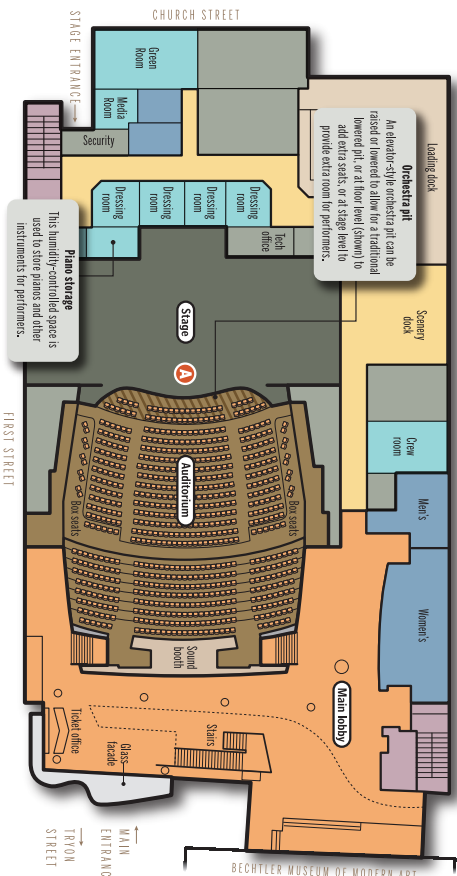

**A** Knight Theater's 100-foot by 40-foot stage will host a wide variety of events but is especially suited for dance productions. The specially designed subfloor – a grid of wooden blocks and baffles – provides a springy surface for dancers to perform on. All visiting shows will find a state-of-the-art facility, including digital sound and light systems.